

Green Pin® Super Shackles

bow shackles with safety bolt

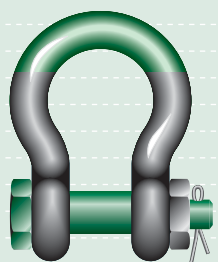

G-5263

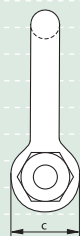
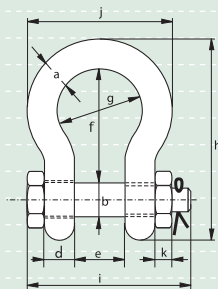

- **Material** : bow and pin alloy steel, Grade 8, quenched and tempered
- **Safety Factor** : MBL equals 5 x WLL
- **Standard** : meets performance requirements of US Fed. Spec. RR-C-271 Type IVA Class 3, Grade B
- **Finish** : hot dipped galvanized (175 ton shackle is painted)
- **Certification** : at no extra charges this product can be supplied with a works certificate, certificate of basic raw material, manufacturer test certificate, EC Declaration of Conformity and all shackles starting from 150 tons are supplied with a Lloyd's Register of Shipping Certificate on proof load

working load limit	diameter bow	diameter pin	diameter eye	width eye	width inside	length inside	width bow	length bow	length bolt	width	thickness nut	weight each
tons	a	b	c	d	e	f	g	h	i	j	k	kg
3.3	13.5	16	34	13.5	22	51	32	91	81	63	11	0.44
5	16	19	40	16	27	64	43	114	99	79	17	0.79
7	19	22	47	19	31	76	51	136	115	94	20	1.26
9.5	22	25	53	22	36	83	58	157	131	107	23	1.88
12.5	25	28	60	25	43	95	68	176	151	124	25	2.78
15	28	32	67	28	47	108	75	197	167	137	28	3.87
18	32	35	74	32	51	115	83	218	179	154	31	5.26
21	35	38	80	35	57	133	92	240	198	170	34	6.94
30	38	42	89	38	60	146	99	262	203	183	19	8.79
40	45	50	104	45	74	178	126	314	244	226	24	15
55	57	57	133	50	83	197	138	365	286	264	27	22.0
85	70	70	159	65	105	260	180	468	342	339	33	42.0
120	83	83	171	75	127	329	190	564	400	371	40	70.0
150*	95	95	215	89	144	381	238	667	440	416	50	112
175*	105	108	245	100	165	400	275	702	490	485	60	160

* = round headed bolt

In inch

working load limit	diameter bow	diameter pin	diameter eye	width eye	width inside	length inside	width bow	length bow	length bolt	width	thickness nut	weight each
tons	a	b	c	d	e	f	g	h	i	j	k	lbs
3.3	1/2	5/8	1 11/32	17/32	7/8	2	1 9/32	3 19/32	3 3/16	2 1/2	7/16	0.97
5	5/8	3/4	1 19/32	5/8	1 3/32	2 17/32	1 23/32	4 1/2	3 29/32	3 1/8	11/16	1.74
7	3/4	7/8	1 7/8	3/4	1 1/4	3	2	5 11/32	4 17/32	3 23/32	25/32	2.78
9.5	7/8	1	2 3/32	7/8	1 7/16	3 9/32	2 9/32	6 5/32	5 5/32	4 3/16	29/32	4.14
12.5	1	1 1/8	2 11/32	1	1 23/32	3 3/4	2 11/16	6 29/32	5 15/16	4 7/8	1	6.13
15	1 1/8	1 1/4	2 5/8	1 1/8	1 7/8	4 1/4	2 15/16	7 3/4	6 19/32	5 3/8	1 1/8	8.53
18	1 1/4	1 3/8	2 29/32	1 9/32	2	4 17/32	3 9/32	8 9/16	7 1/32	6 3/32	1 1/4	11.6
21	1 3/8	1 1/2	3 5/32	1 3/8	2 1/4	5 1/4	3 5/8	9 7/16	7 25/32	6 23/32	1 11/32	15.3
30	1 1/2	1 5/8	3 1/2	1 17/32	2 11/32	5 3/4	3 29/32	10 5/16	8	7 3/16	3/4	19.38
40	1 3/4	2	4 1/8	1 25/32	2 29/32	7	4 15/16	12 11/32	9 19/32	8 29/32	15/16	33.07
55	2 1/4	2 1/4	5 1/4	2	3 9/32	7 3/4	5 7/16	14 3/8	10 19/32	10 3/8	1 3/32	48.50
85	2 3/4	2 3/4	6 1/4	2 9/16	4 1/8	10 1/4	7 3/32	18 3/8	13	13 5/16	1 5/16	92.59
120	3 1/4	3 1/4	6 3/4	2 15/16	5	12 15/16	7 1/2	22 3/16	15 3/4	14 5/8	1 19/32	154.32
150*	3 3/4	3 3/4	8 1/2	3 17/32	5 11/16	15	9 11/32	26 9/32	17 5/16	16 3/8	2	246.92
175*	4	4 1/4	9 5/8	3 15/16	6 17/32	15 3/4	10 13/16	27 5/8	19 9/32	19 1/8	2 3/8	352.74

* = round headed bolt