

HAND RATCHET END FITTINGS

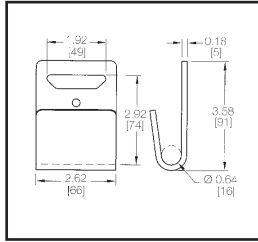

1015 2" FLAT HOOK

Breaking Strength: 10,000 lbs./4,535 kgs.
Working Load Limit: 3,335 lbs./1,513 kgs.
Weight: .73 lbs./.33 kgs.

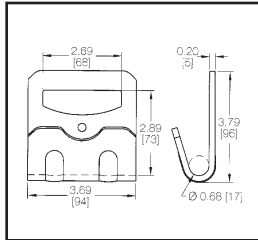

1021 4" FLAT HOOK

Breaking Strength: 15,000 lbs./6,803 kgs.
Working Load Limit: 5,000 lbs./2,268 kgs.
Weight: 1.06 lbs./.48 kgs.

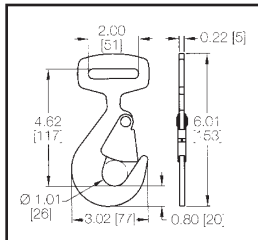

1209 2" SNAP HOOK

Breaking Strength: 10,000 lbs./4,535 kgs.
Working Load Limit: 3,335 lbs./1,513 kgs.
Weight: .61 lbs./.28 kgs.

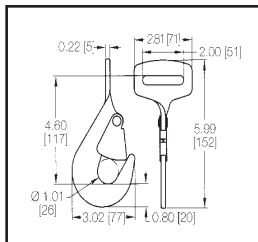

1212 2" TWISTED SNAP HOOK

Breaking Strength: 10,000 lbs./4,535 kgs.
Working Load Limit: 3,335 lbs./1,513 kgs.
Weight: .61 lbs./.28 kgs.

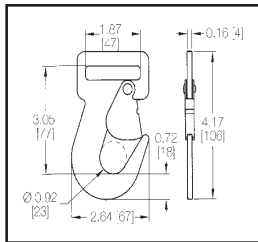

FE7900-1 2" SNAP HOOK

Breaking Strength: 6,000 lbs./2,721 kgs.
Working Load Limit: 2,000 lbs./907 kgs.
Weight: .41 lbs./.19 kgs.

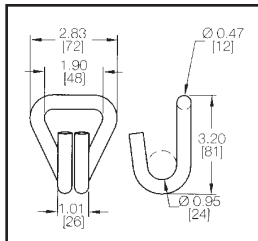

1006 2" NARROW HOOK

Breaking Strength: 10,000 lbs./4,535 kgs.
Working Load Limit: 3,335 lbs./1,513 kgs.
Weight: .58 lbs./.26 kgs.
Note: 3" - 4" Available #1016 WLL 7333 lbs

1023 2" DELTA FLAT RING

Breaking Strength: 10,000 lbs./4,535 kgs.
Working Load Limit: 3,335 lbs./1,513 kgs.
Weight: .29 lbs./.13 kgs.

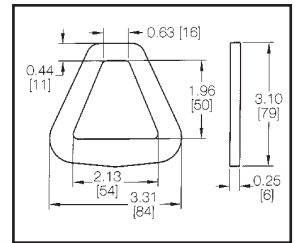

1026 4" DELTA RING

Breaking Strength: 20,000 lbs./9,070 kgs.
Working Load Limit: 6,670 lbs./3,025 kgs.
Weight: 1.36 lbs./0.62 kgs.

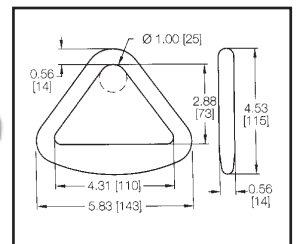

3704 3/8" GRAB HOOK ASSEMBLY

Breaking Strength: 16,200 lbs./7,347 kgs.
Working Load Limit: 5,400 lbs./2,449 kgs.
Weight: 1.22 lbs./0.55 kgs.

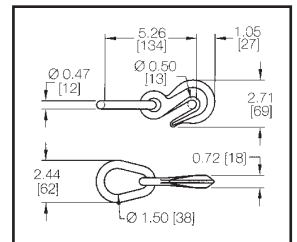

3705 18" CHAIN ANCHOR

Breaking Strength: 16,200 lbs./7,347 kgs.
Working Load Limit: 5,400 lbs./2,449 kgs.
Weight: 2.89 lbs./1.31 kgs.

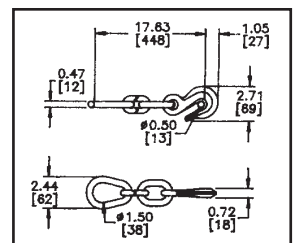

FLATBED ACCESSORY ITEMS

37025

Plastic (2" - 4")
Corner Protectors



10094

Strap Winder



STANDARD LOGISTIC STRAPS



651201 — 12'

2" Webbing with FE8306-1 Spring Fitting, Code 01. Cam Buckle 43010, Webbing 4900, Track Type Series E,A. Assembly Breaking Strength 2,500 lbs. Working Load Limit 835 lbs.



651601 — 16'

2" Webbing with FE8306-1 Spring Fitting, Code 01. Cam Buckle 43010, Webbing 4900, Track Type Series E,A. Assembly Breaking Strength 2,500 lbs. Working Load Limit 835 lbs.



641201 — 12'

2" Webbing with FE8306-1 Spring Fitting, Code 01. Ratchet Buckle 811, Webbing 4900, Track Type Series E,A. Assembly Breaking Strength 3,000 lbs. Working Load Limit 1,000 lbs.



641601 — 16'

2" Webbing with FE8306-1 Spring Fitting, Code 01. Ratchet Buckle 811, Webbing 4900, Track Type Series E,A. Assembly Breaking Strength 3,000 lbs. Working Load Limit 1,000 lbs.



841211 — 12', 831611 — 16' and 832011 — 20'

1-3/4" Webbing with FE8029-1 Spring Fitting, Code 11. Overcenter Buckle FE7707-1, Webbing FE102G, Track Type Series E,A. Assembly Breaking Strength 4,000 lbs. Working Load Limit 1,335 lbs.

LOGISTIC TRACK



43002 SERIES E TRACK HORIZONTAL

High strength steel, 12 gauge. 50,000 psi minimum yield. Iron phosphate, green primer finish. Weight: 16.6 lbs./7.5 kgs. Length: 10 ft./3m.

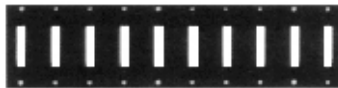

2007 SERIES A TRACK HORIZONTAL

High strength steel, 12 gauge. 50,000 psi minimum yield. Iron phosphate, green primer finish. Weight: 16.6 lbs./7.5 kgs. Length: 10 ft./3m.



FE725-01 ALUMINUM SERIES A TRACK HORIZONTAL

Aluminum. 37,000 psi minimum yield. Natural finish. Weight: 8.3 lbs./3.8 kgs. Length: 10 ft./3m.



2005 SERIES F TRACK HORIZONTAL OR VERTICAL

High strength steel, 15 gauge. Galvanized finish. Weight: 6.9 lbs./3.1 kgs. Length: 10 ft./3m.



2019 SERIES E TRACK VERTICAL

High strength steel, 11 gauge. 50,000 psi minimum yield. Iron phosphate, green primer finish. Weight: 11.6 lbs./5.3 kgs. Length: 10 ft./3m.



FE720-01 SERIES A TRACK VERTICAL

High strength steel, 11 gauge. 50,000 psi minimum yield. Iron phosphate, green primer finish. Weight: 13.2 lbs./6.0 kgs. Length: 10 ft./3m.

All ratings for Series E or A fittings are based on using 43002 or FE702-01 track. Rating may be reduced when fittings are used in other tracks.



OTHER LOGISTIC STRAP HARDWARE



1831
F-Track



1005
Wire Hook



660002
Rope Tie Off



FE8264-1
Series E/A Fitting with 1" Round Ring.
6000 lbs. Breaking Strength. 2000 lbs. WLL.



FE8029-1
Series E/A Spring Loaded Fitting.
4500 lbs. Breaking Strength. 1500 lbs. WLL.