

# CROSBY S-3322 SWIVEL HOOK



Load Rated

## S-322CN / S-322AN



- Forged - Quenched and Tempered.
- Load rating codes stamped on each hook. 322 Swivel Hooks use the same load rating code as 319 Shank Hooks, see page 88 for proper Hook Identification Codes.
- Proper design, careful forging, and precision controlled quench and tempering gives maximum strength without excessive weight and bulk.
- Low profile hook tip designed to utilize Crosby S-4320 or PL-N latch kit. Simply purchase the latch assemblies listed and shown on pages 97-99. Even years after purchase of the original hook, latch assemblies can be added.
- Hoist hooks incorporate markings forged into the product which address two (2) QUIC-CHECK® features:
  - **Deformation Indicators** — Two strategically placed marks, one just below the shank and eye and the other on the hook tip, which allows for a QUIC-CHECK® measurement to determine if the throat opening has changed, thus indicating abuse or overload. To check, use a measuring device (i.e. tape measure) to measure the distance between the marks. The marks should align to either an inch or half-inch increment on the measuring device. If the measurement does not meet this criteria, the hook should be inspected further for possible damage.
  - **Angle Indicators** — Indicates the maximum included angle which is allowed between two (2) sling legs in the hook. These indicators also provide the opportunity to approximate other included angles between two sling legs.

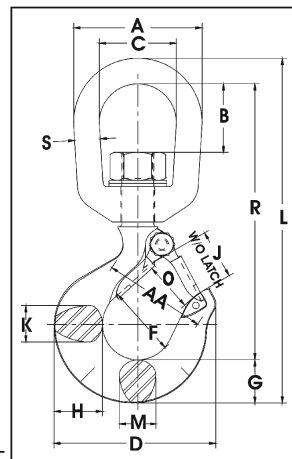

This hook is a positioning device and is not intended to rotate under load. For swivel hooks designed to rotate under load, see pages 85 and 86. Use in corrosive environment requires shank and nut inspection in accordance with ASME B30.10-1.2.(b)(2)(c) 2000.

- U.S. Patents 5,381,650 & 5,193,480 & 5,103,755 and foreign equivalents.

Working Load Limit (t)*		S-322 CN Stock No.	S-322 AN Stock No.	Weight Each (lbs.)	Dimensions (in.)															Rep. Latch Stock No.
Carbon	Alloy				A	B	C	D	F	G	H	J	K	L	M	O †	R	S	AA	
3/4	1	1048600	1048804	.75	2.00	.82	1.25	2.86	1.25	.73	.81	.93	.63	5.66	.63	.89	4.55	.38	1.50	1096325
1	1-1/2	1048609	1048813	1.25	2.50	1.31	1.50	3.15	1.38	.84	.94	.97	.71	6.71	.71	.91	5.37	.50	2.00	1096374
1-1/2	2	1048618	1048822	2.25	3.00	1.50	1.75	3.59	1.50	1.00	1.16	1.06	.88	7.75	.88	1.00	6.12	.63	2.00	1096421
2	3	1048627	1048831	2.30	3.00	1.50	1.75	4.00	1.62	1.13	1.31	1.19	.94	8.25	.94	1.09	6.50	.63	2.00	1096468
3	5	1048636	1048837	4.96	3.50	1.64	2.00	4.84	2.00	1.44	1.63	1.50	1.31	9.69	1.13	1.36	7.50	.75	2.50	1096515
5	7	1048645	1048854	10.29	4.56	2.29	2.50	6.28	2.50	1.81	2.06	1.78	1.66	12.47	1.44	1.61	9.63	1.00	3.00	1096562
7-1/2	11	1048654	1048865	19.40	5.00	2.53	2.75	7.54	3.00	2.25	2.63	2.41	1.88	14.75	1.63	2.08	11.37	1.13	4.00	1096609
10	15	1048663	1048877	23.25	5.62	2.48	3.12	8.34	3.25	2.59	2.94	2.62	2.19	16.40	1.94	2.27	12.25	1.25	4.00	1096657
15	22	1048672	1048886	47.00	7.10	3.76	4.10	10.34	4.25	3.00	3.50	3.41	2.69	21.34	2.38	3.02	16.71	1.50	5.00	1096704
-	30	-	1025688	70.50	7.10	3.76	4.10	13.62	5.00	3.61	4.63	4.00	3.00	23.25	3.00	3.25	18.01	1.50	6.50	1093716

\* NOTE: Carbon swivel hooks .75tC-15tC: proof load is 2 times working load limit. Designed with a 5 to 1 design factor.  
 Alloy swivel hooks 1tA-22tA : proof load is 2.5 times working load limit. Designed with a 4.5 to 1 design factor.  
 Alloy swivel hook 30tA: proof load is 2 times working load limit. Designed with a 4 to 1 design factor.

† Dimensions for hooks 3/4 ton carbon thru 22 ton alloy are for S-4320 latch kits. Dimensions for hooks 30 ton alloy are for PL latch kit.

SEE APPLICATION AND WARNING INFORMATION ON PAGE 84.

